

SOLD

88 Leo Lindo Drive, Shailer Park

Welcome to 88 Leo Lindo Drive - a captivating family home located in Shailer Park's premier blue-chip address. Enjoying scenic bushland surrounds from the superb 1424m2 allotment, the immaculate home is positioned for the ultimate in privacy and offers an exceptional lifestyle for your family. Inside, high ceilings and tranquil bushland views add to the sense of wide-open space, and strong architectural angles make an opulent statement. Plenty of natural light infiltrates the interior which has a calm and welcoming ambiance. The home is immaculate albeit largely original, inspiring for those looking to add their own personal updates to this stunning property.

...

4  2  2 

Price: \$1,085,000

View: <https://markcoleman.com.au/7164986>

Mark Coleman Team

M 0434169033

RE/MAX Property Specialits,
Narrabeen

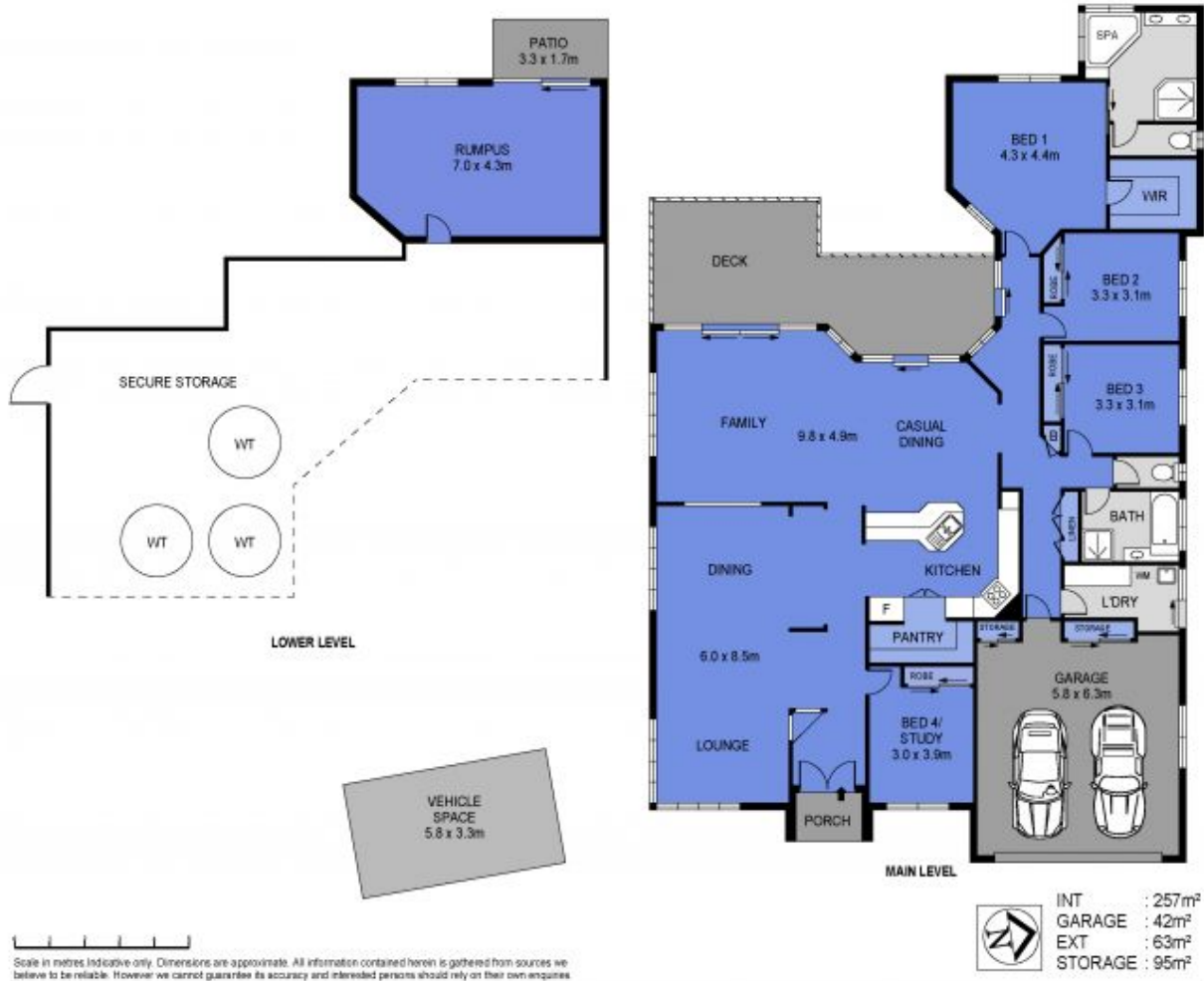

Scale in metres indicative only. Dimensions are approximate. All information contained herein is gathered from sources we believe to be reliable. However we cannot guarantee its accuracy and interested persons should rely on their own enquiries.

88 Leo Lindo Drive, Shailer Park